

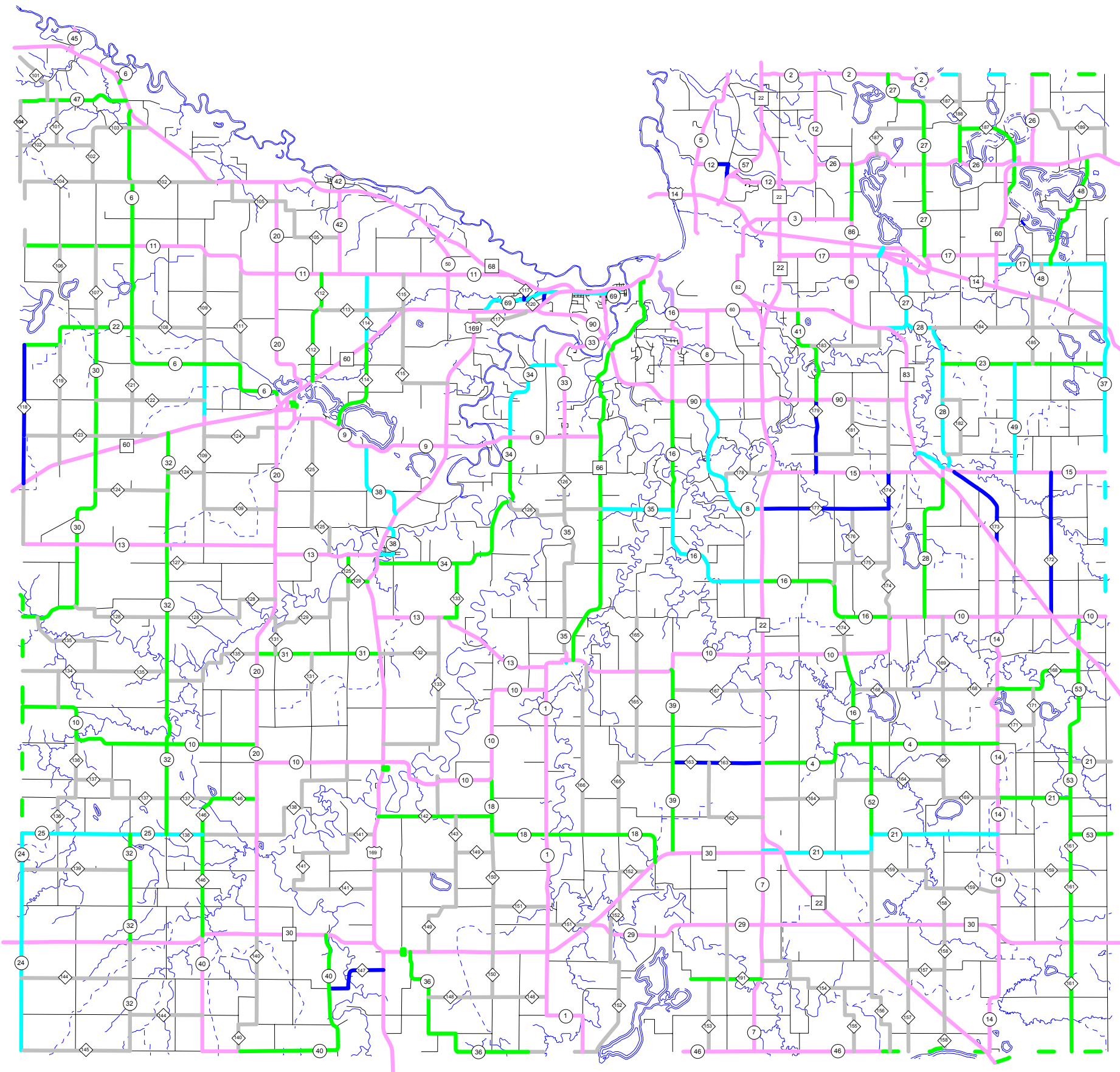





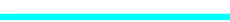

BLUE EARTH COUNTY SPRING WEIGHT POSTINGS

2006

March 8 to
April 5 Minimum
May 3 Maximum



-  10 TON
 -  9 TON
 -  7 TON
 -  5 TON
 -  5 TON GRAVEL
 -  5 TON TOWNSHIP ROAD
 -  BORDER ROAD
- COLOR INDICATES POSTING



WEBSITE FOR FURTHER INFORMATION:
<http://mnroad.dot.state.mn.us>

Map is available in PDF format at
<http://www.co.blue-earth.mn.us>